

# Quick Start Guide

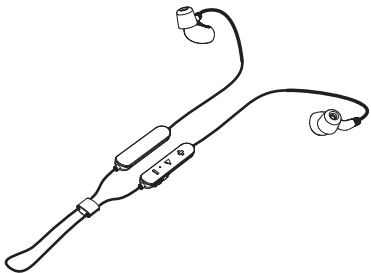

## SD251-BT

Studio Monitoring Earphones with Bluetooth\* Connectivity

V 1.0



### LEGAL DISCLAIMER

Music Tribe accepts no liability for any loss which may be suffered by any person who relies either wholly or in part upon any description, photograph, or statement contained herein. Technical specifications, appearances and other information are subject to change without notice. All trademarks are the property of their respective owners. Midas, Klark Teknik, Lab Gruppen, Lake, Tannoy, Turbosound, TC Electronic, TC Helicon, Behringer, Bugera, Oberheim, Auratone and Coolaudio are trademarks or registered trademarks of Music Tribe Global Brands Ltd. © Music Tribe Global Brands Ltd. 2021 All rights reserved.

### LIMITED WARRANTY

For the applicable warranty terms and conditions and additional information regarding Music Tribe's Limited Warranty, please see complete details online at [musictribe.com/warranty](https://musictribe.com/warranty).

### ⚠ Important Safety Information

1. Read these instructions.
2. Keep these instructions.
3. Heed all warnings.
4. Follow all instructions.
5. Do not use this apparatus near water.
6. Clean only with dry cloth.
7. Do not throw this product in the fire, to avoid explosion.
8. Do not expose this product to bright sunshine for a long time.
9. Do not disassemble or modify this product.
10. Please store this product in a clean and dry environment.
11. Charge it once a month (minimum).
12. Do not leave unattended while charging.
13. **WARNING!** Choking and Swallowing Hazard. Keep the product safely out of reach of children and pets. The small size presents a choking and swallowing hazard. Failure to follow instructions may lead to permanent damage or death.
14. **WARNING!** To prevent possible hearing damage, do not listen at high volume levels for long periods.

### Accessories List

- SD251-BT earphones x 1 pair
- Zipper case
- Silicone sleeves in 3 sizes
- USB charging cable
- Cleaning tool
- This quick start guide

### Features

- Professional studio-grade monitoring earphones
- Dynamic micro-driver provides wide frequency response (20 Hz - 20 kHz) delivering full bass and detailed highs
- Bluetooth\* 5.0 technology for exceptional sound quality with up to 33 ft (10 m) of wireless freedom
- Built-in CVC 8.0 isolates the user's voice from surrounding clutter for clear phone conversation
- Sound-isolating design blocks outside noise for detailed musical experience
- Secure, over-the-ear cable design ensures in-ear stability and comfort
- 360-degree rotating gold-plated MMCX lock-snap connector for flexibility and versatile connectivity options
- Bluetooth communication cable for seamless phone calls and effortless music controls
- Up to 7-hours of battery life - USB charging cable included
- Zipper case included to enjoy your music on-the-go
- Includes foam and silicone ear-plugs in 3 sizes to ensure a perfect fit

### Controls

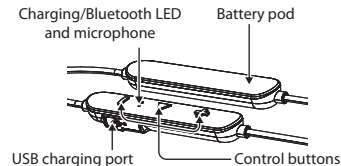

### Getting Started

#### Charging

- Before use, please read this quick start guide carefully and keep it in a safe place.
- Please fully charge the earbuds before use.
- Do not leave unattended while charging.
- Please regularly charge the earbuds if you do not use them for a long time (more than 3 months).
- Please use the supplied charger cable only.
- There is built-in easy voice prompt for low battery that informs the user to recharge the device.

#### WARNING: Avoid the following

- Replacement of a battery that can defeat a safeguard.
- Disposal of a battery into fire or a hot oven, or mechanically crushing or cutting of a battery, that can result in an explosion.
- Leaving a battery in an extremely high temperature surrounding environment that can result in an explosion or the leakage of flammable liquid or gas.
- A battery subjected to extremely low air pressure that may result in an explosion or the
- leakage of flammable liquid or gas.

## Wearing, inserting and removing the earphones

1. These earphones should be worn with the cables routed over the ear. Then, the cables can be run to your monitoring system either in front or behind, similar to this illustration:



2. Insert each earphone so makes a tight seal in the ear canal. A good seal with the ear canal is necessary for optimum sound quality, especially for bass frequencies.



3. If you notice a loss of bass frequencies, gently push the earphone deeper into the ear canal to produce a better seal. If this adjustment does not improve the bass response, you can also switch to a different sleeve.

**WARNING:** Avoid pushing the earphone in beyond the ear canal.

4. To remove the earphones, firmly hold each earphone's outer case between your finger and thumb and twist gently.



## Choosing, installing and changing sleeves

SD Series earphones come with a selection of soft sleeves in three sizes, from small to large

**WARNING:** Always make sure to protect your ears by muting or lowering your monitoring system's volume down all the way before inserting the earphones.

1. Choose an earphone sleeve with the best fit and the best seal to isolate your earphone mix from outside sounds.
2. Slide the sleeve onto each earphone's sound nozzle. Apply light pressure, and if necessary rotate the sleeve as you go until secure.
3. Make sure the sleeve completely covers the nozzle and the flared barb.

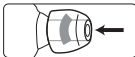

4. Try inserting the earphone into your ear canal to test the fit.
5. If the fit is too loose or tight, twist and pull to remove the sleeve from the nozzle and replace with a sleeve in the next appropriate size.

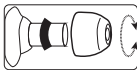

**NOTE:** If the barb or nozzle is exposed beneath the sleeve, the sleeve is not installed properly. Sleeves that do not fit securely over the nozzle and barb should be replaced.

## Bluetooth pairing

You will hear voice prompt for pairing after power on. Please refer to function map table for other functions.

Bluetooth functions for Bluetooth-enabled earphones can be accessed from the controller pod embedded in the earphone cable:



## Power ON / OFF

Power On	Press center key for 3 seconds
Power Off	Press center key for 3 seconds

## Music Controls

Play the Track	Press center key once
Pause the Track	Press center key once
Volume Up by 7%	Press "+" key
Volume Down by 7%	Press "-" key
Next Track	Long Press "+" key
Previous Track	Long Press "-" key

## Mic Control

Mic mute / unmute	Long press center key
-------------------	-----------------------

## Voice Assist Control

Activate Voice Assist	Press center key three times
-----------------------	------------------------------

## LED Indication

Mode	LED color/activity
Charging	Red
Fully charged	Red light will turn off
Pairing mode	Red and Blue lights flashing alternately
Bluetooth connected	Blue

## Cleaning

1. If you notice problems with sound quality not related to the fit inside the ear canal, remove the sleeve and check the earphone nozzle for obstructions.
2. If the nozzle is blocked, use the included cleaning tool to clear the block.

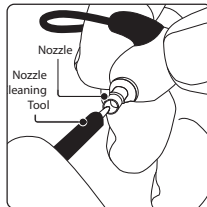

3. Replace the sleeve onto the nozzle, and re-insert the earphones into your ear to test the sound.

## Maintenance tips

- Keep the earphones and sleeves clean and dry.
- To clean, remove the sleeves from the earphone nozzle, gently rinse in warm water and allow to air dry. Sleeves should be completely dry before
- Inspect sleeves for damage and replace as necessary.
- Avoid exposing the sleeves to extreme temperatures.
- Replace sleeves that do not fit properly.

## Specifications

Driver	6.8 mm
Impedance	22 Ω
Frequency response	20 Hz to 20 kHz
Sound pressure level (SPL)	93 dB @1kHz (105 dB peak)
Rated power	3 mW
Bluetooth*	Version 5.0
Frequency range	2402 MHz ~ 2480 MHz
Channel number	79
Max output power	5 dBm
Bluetooth range	Up to 10 m (33 ft) in line of sight

CODEC support	aptX, AAC, SBC
Call support	CVC 8.0
Mic sensitivity	-42 dB (±3 dB) @ 1 kHz, 0 dB = 1 V/Pa
Battery type	Rechargeable lithium battery
Working time	Up to 7 hrs
Standby time	Up to 150 hrs
Charging time	1 hr via USB 5 V / 500 mA
Cable	Shielded, detachable
Connector	MMCX connector, detachable
Cable length	25 cm (10")

\*The Bluetooth® word mark and logos are owned by the Bluetooth SIG, Inc., and any use of such marks by Music Tribe is under license.

## Other important information

**Register online.** Please register your new Music Tribe equipment right after you purchase it by visiting [behringer.com](https://www.behringer.com). Registering your purchase using our simple online form helps us to process your repair claims more quickly and efficiently. Also, read the terms and conditions of our warranty, if applicable.

**Malfunction.** Should your Music Tribe Authorized Reseller not be located in your vicinity, you may contact the Music Tribe Authorized Fulfiller for your country listed under “Support” at [behringer.com](https://www.behringer.com). Should your country not be listed, please check if your problem can be dealt with by our “Online Support” which may also be found under “Support” at [behringer.com](https://www.behringer.com). Alternatively, please submit an online warranty claim at [behringer.com](https://www.behringer.com) BEFORE returning the product.

## FEDERAL COMMUNICATIONS COMMISSION COMPLIANCE INFORMATION

### Behringer

**SD251-BT**

Responsible Party Name: **Music Tribe Commercial NV Inc.**  
Address: **5270 Procyon Street,  
Las Vegas NV 89118, United States**  
Phone Number: **+1 702 800 8290**

### SD251-BT

This equipment has been tested and found to comply with the limits for a Class B digital device, pursuant to part 15 of the FCC Rules. These limits are designed to provide reasonable protection against harmful interference in a residential installation. This equipment generates, uses and can radiate radio frequency energy and, if not installed and used in accordance with the instructions, may cause harmful interference to radio communications. However, there is no guarantee that interference will not occur in a particular installation. If this equipment does cause harmful interference to radio or television reception, which can be determined by turning the equipment off and on, the user is encouraged to try to correct the interference by one or more of the following measures:

- Reorient or relocate the receiving antenna.
- Increase the separation between the equipment and receiver.
- Connect the equipment into an outlet on a circuit different from that to which the receiver is connected
- Consult the dealer or an experienced radio/TV technician for help.

This device complies with Part 15 of the FCC rules. Operation is subject to the following two conditions:

- (1) this device may not cause harmful interference, and
- (2) this device must accept any interference received, including interference that may cause undesired operation.n.

### Important information:

Changes or modifications to the equipment not expressly approved by Music Tribe can void the user's authority to use the equipment.