

YAMAHA ELECTRONIC DRUM KIT
DTX **DTX6K5-M**
 Assembly Manual EN VGY0460

Thank you for purchasing the Yamaha Electronic Drum Kit DTX6K5-M. This electronic drum kit can be used in your home or a studio, or onstage for live performances. For proper assembly and safe use, please read this assembly manual carefully before using it. After you have read the manual, keep it in a safe and handy place for future reference. This manual describes the process of installing a pad set and drum trigger module for an already assembled RS6 electronic drum rack. It also covers assembly, wiring, and then setting up the drum trigger module as shown below. Before reading this manual, therefore, be sure to assemble your RS6 as described in the owner's manual that came with it.

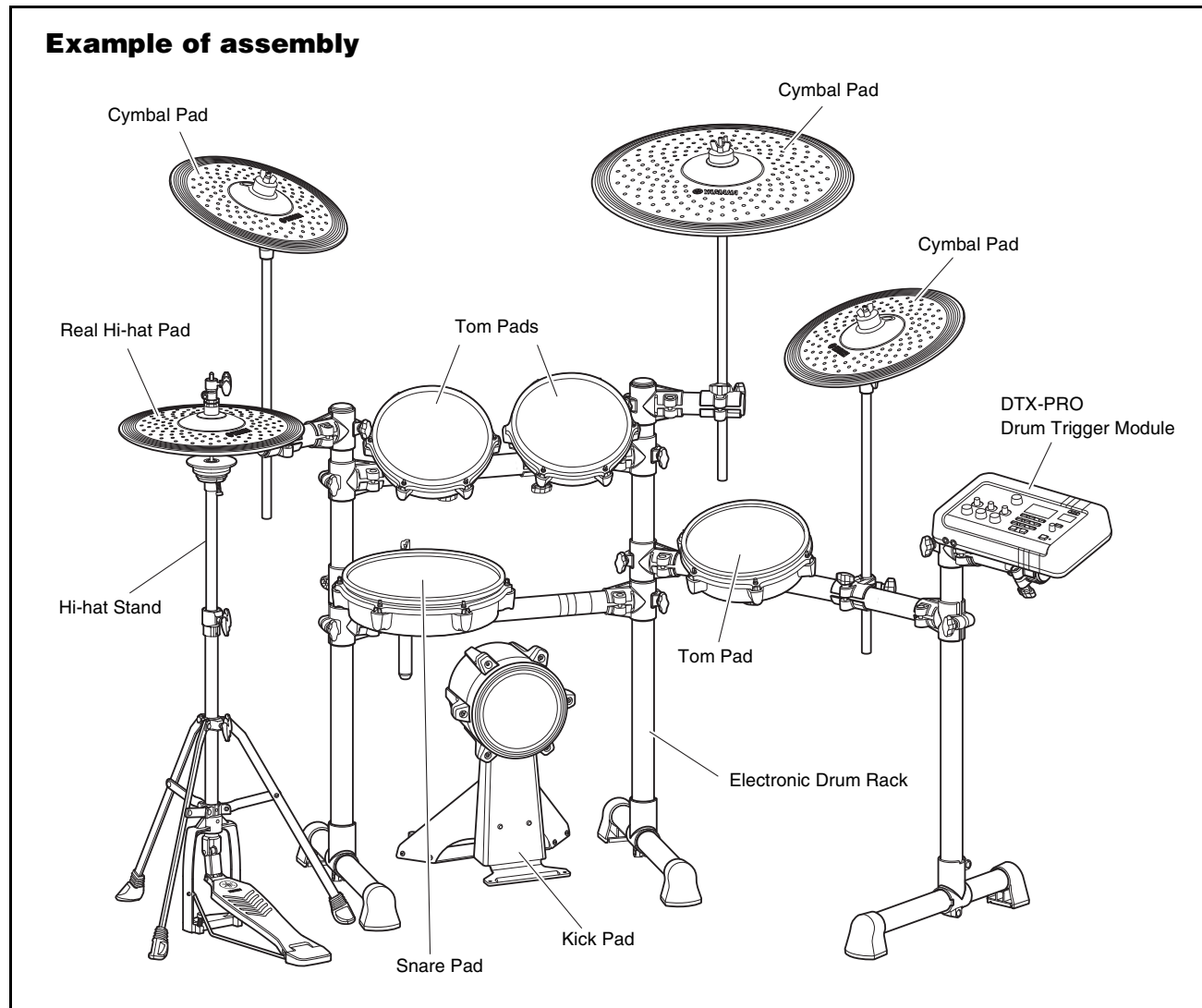

NOTICE
 If you have a drum mat (sold separately), lay it on the floor first. If you do not have a drum mat, lay a piece of packing cardboard under the hi-hat stand and kick pad to prevent scratches on the floor.

1 Open the boxes to reveal their contents.
 After opening up the packages containing your electronic drum kit, please verify that all of the following components are present.

Components of DTX6K5-M

- Snare Pad XP120L-M (x 1)
- Tom Pad XP100L-M (x 3)
- Stopper for PCY155 or PCY135 (x 3)
- Stand Base for RHH135 (x 1)
- Hi-hat clutch for RHH135 (x 1)
- RHH135 Real Hi-hat Pad (x 1)
- PCY135 Cymbal Pad (x 2)
- PCY155 Cymbal Pad (x 1)
- Cable band (x 9)
- Cable band for RHH135 (x 1)
- HS650A Hi-hat Stand (x 1)
- KP90 Kick Pad (x 1)
- Anti-slip stoppers for KP90 (incl. springs) (x 2)
- Drum key (x 1)
- DTX-PRO Drum Trigger Module (x 1)
- Module holder (x 1)
- DTX6K5-M Assembly Manual (this leaflet; x 1)
- PCY100/PCY135/PCY155/PCY175 Owner's Manual (x 1)
- RHH135 Owner's Manual (x 2)
- XP100L-M/XP120L-M Owner's Manual (x 1)
- KP90 Owner's Manual (x 1)
- Ten-channel snake cable (x 1)
- AC adaptor (x 1)
- DTX-PRO Owner's Manual (x 1)
- Cubase AI Download information (x 1)

IMPORTANT
 For details on the warranty for the included pads and RS6 Electronic Drum Rack, refer to the warranty card included in each owner's manual.

2 Assemble the RS6 Electronic Drum Rack.
 For instructions on how to assemble the RS6 Electronic Drum Rack, refer to the owner's manual that came with the rack.

3 Attach the pads and the drum trigger module to the electronic drum rack.

PRECAUTIONS Please read carefully before proceeding

The purpose of the precautions detailed below is to ensure that this electronic drum kit can be used safely without fear of injury or property damage. As a means of indicating the severity and immediacy of any risk of injury or property damage resulting from incorrect operation, these precautions are classified as either WARNING or CAUTION. The instructions displayed together with these precautions are extremely important in terms of ensuring safety, and therefore, they should be fully observed.

- After reading this Assembly Manual, ensure that it is kept in a safe, convenient location for future reference.
- Be sure to also read the Assembly Manuals and/or Owner's Manuals that came with your pads and rack.

CAUTION Failure to observe the precautions described below can result in injury and/or property damage.

- Assemble this product in the proper sequence by following the assembly instructions in this manual. Also, make sure to tighten the bolts regularly. Failure to do so might result in damage to the product or even injury.
- Young children using this electronic drum kit should be supervised by a guardian to eliminate any possibility of injury.
- Holders for cymbal and tom pads have sharp tips. In order to avoid injury, therefore, you should take special care whenever handling these components.
- The anti-slip stoppers on kick pads and foot pedals have sharp tips. In order to avoid injury, therefore, you should take special care whenever handling these components.
- If this product is used with a stand or rack system, be sure to securely tighten nuts and other fasteners when setting up this product. In addition, when loosening all nuts and other fasteners, be sure to proceed slowly while holding the kit securely with your hands. Otherwise, this product or a part of the rack or stand may fall or topple, possibly causing injury.
- Do not set up this electronic drum kit on a slope, on an unstable platform, or on any other unsafe surface. If this precaution is not observed, it may topple over or fall, possibly causing injury.
- Whenever setting up this electronic drum kit, ensure that cables and the like are arranged safely. If someone were to trip on a cable, the kit could topple over and cause injury.
- Under no circumstances should this electronic drum kit be disassembled or customized. Failure to observe this precaution can result in injury or malfunction.
- Do not sit or stand on the rack. Doing so could cause it to fall over or break, possibly causing injury.

CAUTION Failure to observe the precautions described below can result in injury and/or property damage.

- Do not insert your hands or fingers into a gap in the joint section when adjusting clamps. They can easily be pinched and injured if care is not taken during this operation.
- Be careful with the tips of supports, arms, screws, and the like. Fingers can easily be injured by sharp tips if these components are not handled carefully.
- Do not place hands or feet under the high-hat stand, kick pad, or foot pedal. Doing so could result in injury.
- Do not use the electronic drum kit's rack to hold acoustic drums. Doing so could cause clamps to break and the drums to fall off, which in turn could lead to injury.

NOTICE: Usage Precautions

- When connecting and disconnecting cables, be sure to hold the plug and not the cable itself. In addition, avoid placing heavy items on top of cables and do not allow them to touch sharp edges. Failure to avoid these precautions can lead to cable breakage and disconnection.
- Do not climb onto the electronic drum kit and avoid placing heavy objects on it. Failure to observe this precaution can result in malfunction.
- Avoid using or storing the electronic drum kit in very hot locations (i.e., in direct sunlight, in close proximity to a heater, or in a closed vehicle) or in highly humid locations (i.e., in a bathroom or outdoors in wet weather). Failure to observe this precaution can lead to warping, discoloration, malfunction, or breakdown.
- Avoid cleaning the electronic drum kit with organic solvents, paint thinner, or alcohol as these substances can cause warping and discoloration. Instead, we recommend you remove dust using a soft dry cloth or wipe clean using a moist, tightly-wrung cloth. If the electronic drum kit is very dirty, first wipe the dirt away using a cloth moistened with a neutral detergent solution and tightly wrung. Following this, wipe away the detergent solution using a cloth soaked in water and tightly wrung.
- Do not place a vinyl, plastic, or rubber product on the electronic drum kit. Doing so may cause discoloration or deterioration of the kit.

The illustrations in this owner's manual are for instructional purposes only.
 The company names and product names in this manual are the trademarks or registered trademarks of their respective companies.
 The contents of this manual apply to the latest specifications as of the publishing date. To obtain the latest manual, access the Yamaha website then download the manual file. Since specifications, equipment or separately sold accessories may not be the same in every locale, please check with your Yamaha dealer.

Attaching the snare and tom pads

1. Loosen the clamp bolt that is attached to each pad.

2. Attach each pad to the corresponding rod, and then tighten the clamp bolt to secure the pad.

Adjusting the pads
 You can adjust the position and angle of each pad to your liking. Loosen the bolts shown below, and once the position and angle are decided, tighten the bolts securely to secure them in place.

NOTICE
 Leave a gap of about one finger width between the clamp for the Snare Pad and XP120L-M. Keep in mind that contact between both could damage the pad.

Continued on other side →

Assembling the Hi-hat Stand and attaching the Hi-hat Cymbal Pad

- Loosen the hi-hat stand's wing bolt (●, as shown below).
- Open up the three legs as shown below and then retighten the wing bolt (●) to lock them in place.
- Insert the footboard stabilizer rods into the frame holes as shown below.

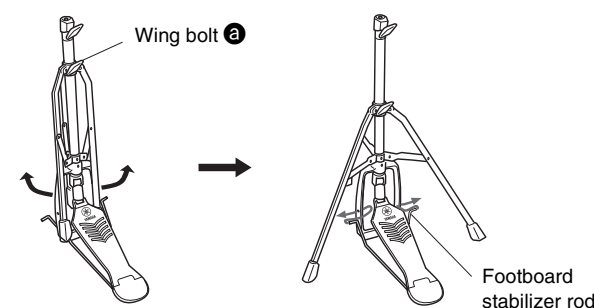

- Loosen the hi-hat clutch's wing bolt (●, as shown at right) and remove the hi-hat clutch.
 - Because the hi-hat clutch removed here will not be used in the assembly instructions in this manual, please keep it in a safe place. Instead, the hi-hat clutch included with the RHH135 will be used.
- Remove the hi-hat shaft (B) from the upper tube (A).

- Insert the hi-hat shaft (B) (removed in Step 5) as far as it will go into the lower tube (C) and screw in the tip.
- Insert the upper tube (A) over the hi-hat shaft (B) and tighten the wing bolt (●, as shown in the illustration at right) to secure it in place with the cymbal support plate approximately half way between the top of the lower tube (C) and the top of the hi-hat shaft (B).
- Remove the felt washer attached above the cymbal support plate. It is not required when assembling the electronic drum kit in the standard fashion described in this manual.
- Attach the RHH135 Real Hi-hat Pad.
 - For detailed instructions, refer to the "Setting Up" in the RHH135 Owner's Manual.

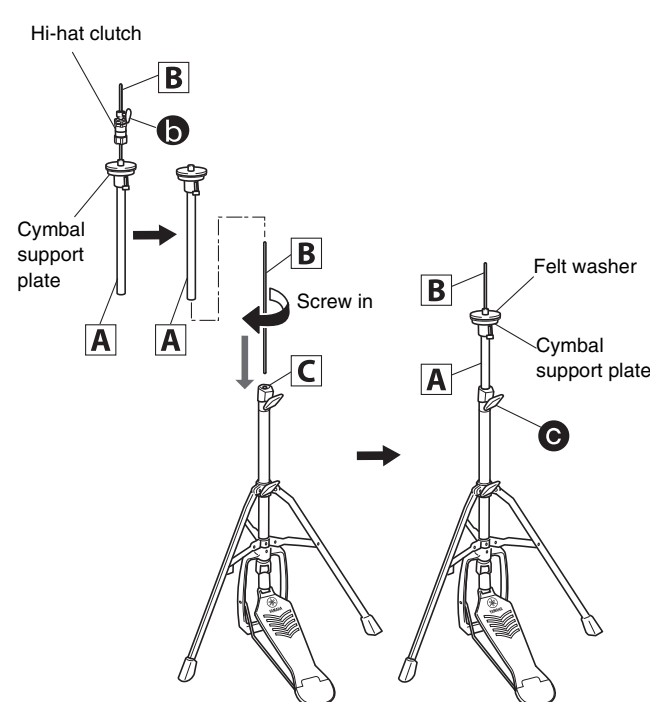

IMPORTANT

The hi-hat shaft will become loose while you continue to use the hi-hat, and the hi-hat pad may rotate. Since this may adversely affect performance, screw in the hi-hat shaft periodically and adjust the position of the hi-hat pad.

Attaching the drum trigger module and cymbal pads

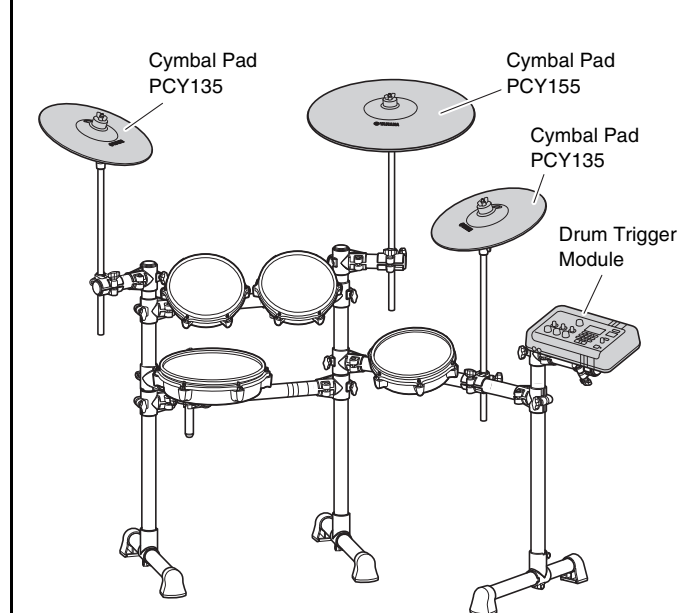

Attaching the drum trigger module

- Secure the module holder to the bottom of the drum trigger module using the module holder screws.
 - Module holder screw (x 4)
- Insert the module holder into the holder clamp and tighten the clamp bolt to secure it in place.
 - Module holder
 - Drum Trigger Module (bottom)
 - Clamp bolt
 - Holder clamp

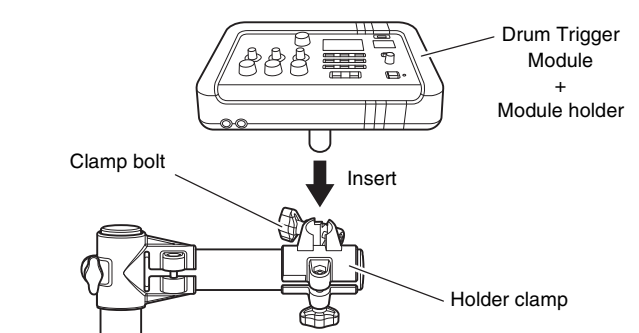

Attaching the cymbal pads

- Using the drum key, loosen the stopper's key bolt.
 - Stopper
 - Key bolt
 - Drum key
- Remove the wing nut, the two felt pads, and the bolt cover from the cymbal holder.
 - Wing nut
 - Felt pads
 - Bolt cover
 - Cymbal holder
- Place the stopper on the cymbal holder.
 - Stopper
 - Cymbal holder

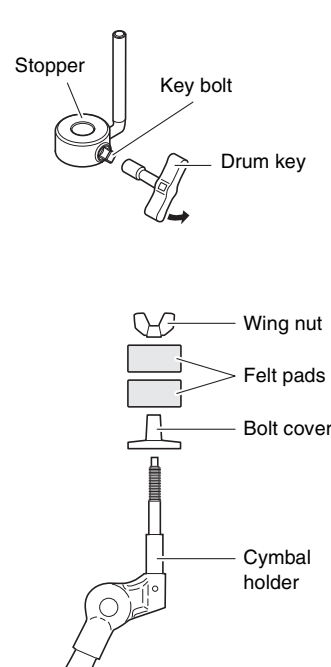

- Replace the bolt cover.
 - Turn the bolt cover to tighten it onto the threaded section and firmly secure it in place.
 - Bolt cover
 - Stopper
 - Threaded section
 - Cymbal holder
- With the stopper making full contact with the bottom surface of the bolt cover as shown below, tighten the stopper's key bolt using the drum key.
 - Drum key
 - Bolt cover
 - Full contact
 - Stopper
 - Cymbal holder

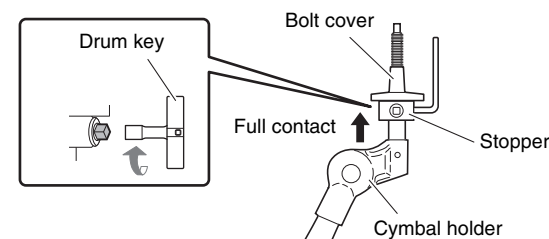

- Mount the pad on the cymbal stand. Lower the pad into place with the cymbal holder's shaft passing through the central hole. When mounted, the stopper's pin should rest inside the pad's smaller hole.
 - If you were to play your Cymbal pad without the stopper's pin positioned well inside the smaller hole, the pad could rotate, causing the pin to be pulled out. It is very important, therefore, to ensure that the stopper is secured as shown in Step 5.
- Replace the other felt pad (removed in Step 2) to the cymbal holder.
- Tighten the wing nut to secure the pad to the cymbal holder.
 - Wing nut
 - Stopper's pin
 - Felt pad removed in Step 2
 - Cymbal Pad
 - Smaller hole
 - Cymbal holder
 - Pin
 - Bolt cover
 - Stopper
 - Cymbal holder

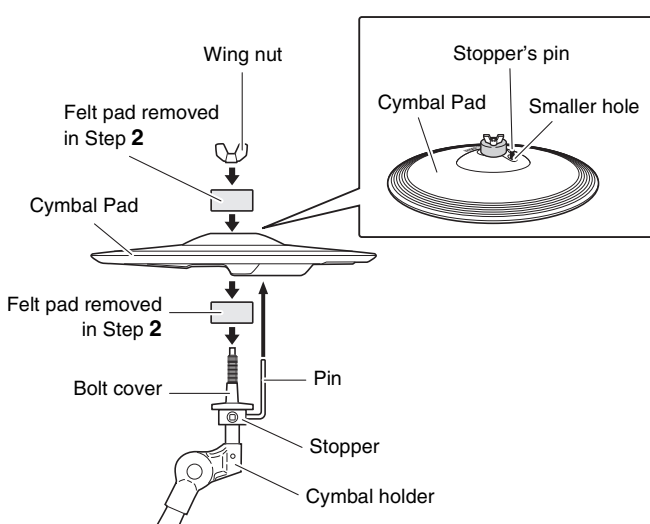

IMPORTANT

You can play comfortably by striking near the Yamaha logo. Adjust the height, angle and orientation of the cymbal pad and hi-hat pad to a position where you can hit around the Yamaha logo naturally when performing. If the Yamaha logo on the cymbal and hi-hat pads are visible in front of the performer, the pad positions are correctly set. Refer to the illustration below to adjust the orientation of the stopper so that the orientation of the cymbal pad will be correct. In addition, adjust the orientation of the hi-hat clutch so that the orientation of the hi-hat pad will be correct.

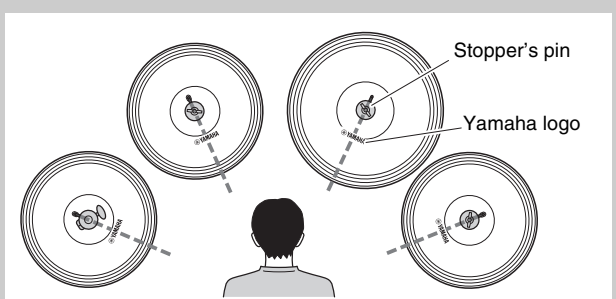

Assembling the kick pad

- Remove the two wing bolts from the kick pad frame, and then place them nearby.
- Join the base to the frame as shown to the right, and then secure it in place by the wing bolts (removed in the previous Step) from the base side.

NOTE
For details on attaching the foot pedal (sold separately), refer to the "Assembling the KP90" in the KP90 Owner's Manual.

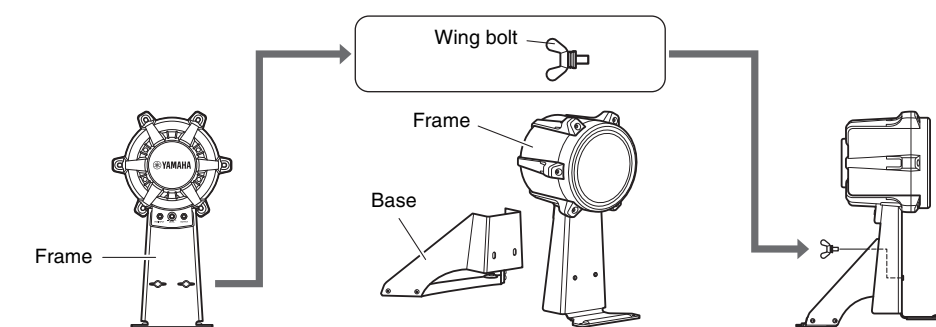

- Arrange the hi-hat stand and the kick pad as shown in "Example of standard assembly" on the other side of this sheet.
 - NOTICE** Do not lower the electronic drum rack's center strut too much. Doing so may cause the rack to come into contact with the kick pad.

- Connect the pads to the drum trigger module using the ten-channel snake cable.

- Plug the straight ends of the ten-channel snake cable into the trigger input jack (●, ●, as shown below) on the rear panel of the drum trigger module.
 - For the standard setup, refer to the pad name labeled on each plug of the snake cable.
- Plug the L-shaped ends of the ten-channel snake cable into the corresponding pad into the jack of the corresponding pad.

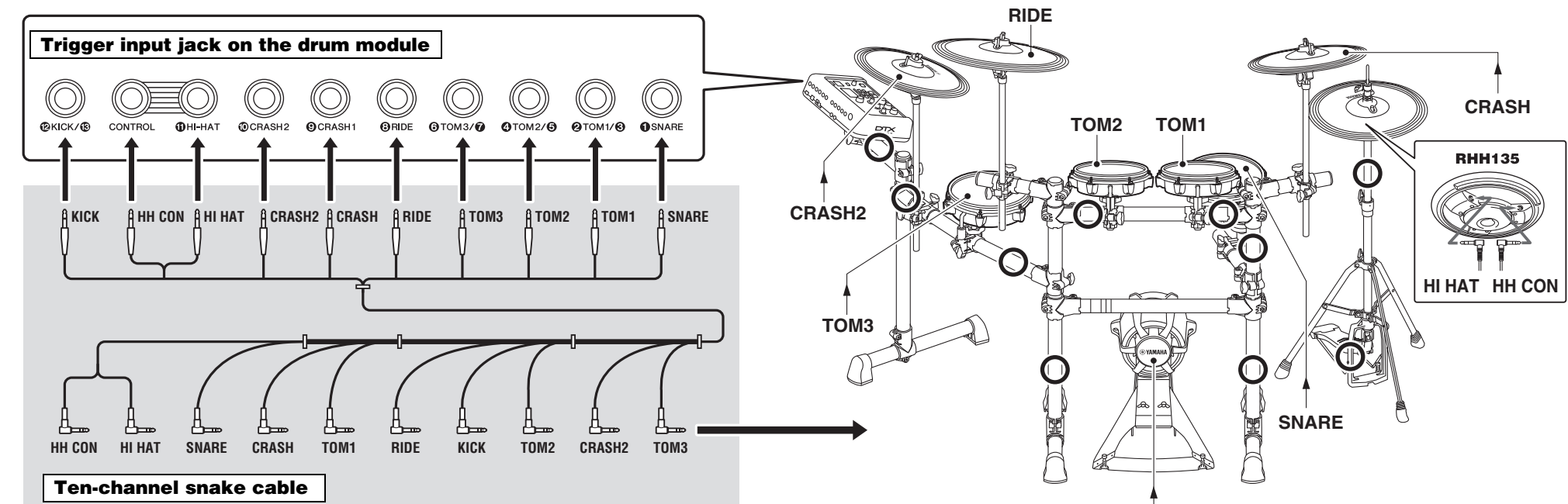

- Using the cable bands, secure the cables to the electronic drum rack at the positions circled (○) in the figure on the right.

For a neat setting, it is a good idea to fasten the cable bands starting from the side closest to the Drum Trigger Module in sequence.

- Connect the AC adaptor to the drum trigger module and then turn on the power to the module.

- Plug the DC cord of the AC adaptor into the 12V connector as shown and wrap the DC cord around the cord hook to secure it in place.

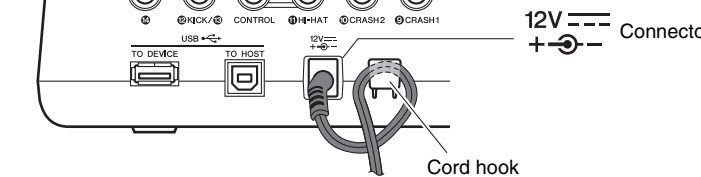

- Plug the AC cord of the adaptor into a domestic wall socket.
- Turn the [MASTER VOLUME] knob counterclockwise all the way to set the volume to minimum.
- Press the [ON] (Standby/On) switch to turn on the power to the module. When you turn on the power to the module for the first time after purchase, the "Initial Settings (Trigger Setup Wizard)" screen is displayed. Proceed to Step 7.

If the power has already been turned on and the initial settings have been completed:

- Press the [MENU] button.
 - Select "Job" -> "Trigger" -> "Trigger Setup."
- In this case, the illustration in Step 7 differs from what is displayed on the module screen. However, the trigger setup operations will be the same.

- Set up the drum trigger module.

IMPORTANT

Be sure to follow this procedure to ensure proper sensitivity when hitting the pads.
If "DTX6K5-M" does not appear in Step 2 below, you will need to update the firmware. For details, refer to the Yamaha website.

- Press the button indicated by the arrow as shown below.
- When "DTX6K5-M" appears, press the button as shown below.
- When a confirmation message appears, press the button as shown below.

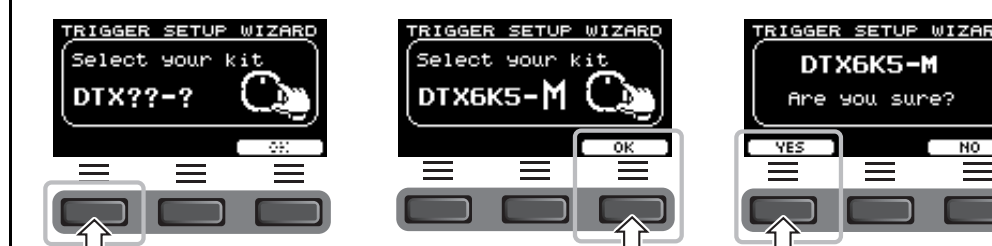

Adjusting the kick pad output (LEVEL):
You can adjust the trigger output to the desired level by using the KP90 kick pad's level adjustment knob. For details, refer to "Adjusting the Output Level" in the KP90 Owner's Manual.

Adjusting the positions of the electronic drum rack legs:
If you are concerned about instability or shaking of the electronic drum rack, refer to steps 4-1 to 4-3 of "Assembling the rack" in the RS6 Owner's Manual to adjust the position of the legs.

For subsequent instructions including how to play, refer to the Owner's Manual that came with the module.